



Jemiclاد

North America



The Commercial Kitchen Bible
Finishes for Commercial Kitchens.

**Jemiclاد Sureclاد Smooth is the Upgraded,
Class A fire Rated, Food Safe, PVC
Alternative to Old, Outdated, Sub Standard
Potentially Dangerous FRP**

Co-extruded joint trims for a water tight seal.

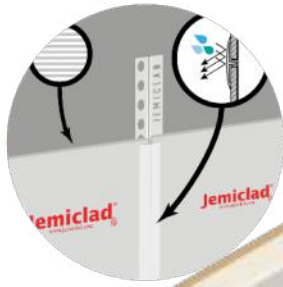

Heat formed corners to eliminate trims and improve hygiene.

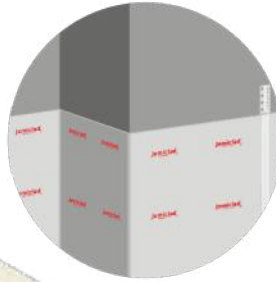

Cold weld your vertical joints to give a flush finish.

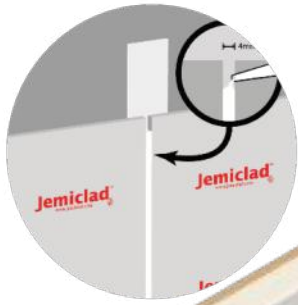

Stainless Steel to walls where the temperature is likely to exceed 140F

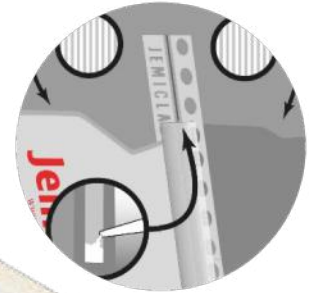

Be sure to check out all the great Jemiclad colours available for your wall protection in the front of the house . For information on colours and availability reach out to www.jemicladcanada.com



Jemiclad sheets meeting poured resin cove base detail

– Jemiclad horizontal joint or installing above the maximum sheet height

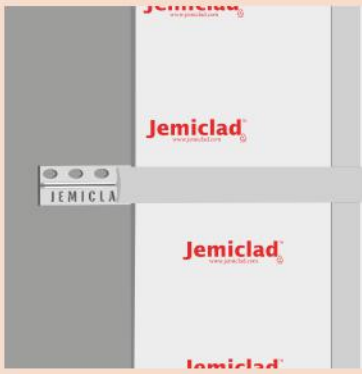

1. When your achieved height of Jemiclad exceeds 3m, you need to add to the panel. You can use a joint strip or hot weld the joint.

2. The maximum sheet height is 3m. A larger panel can be ordered in, Jemiclad Pro or Jemiclad Cocina Clad, 12 weeks notice is required.

Joining profiles have the maximum length of 3m, except Jemiclad Weld Rod comes in coils of (at least) 50m to 300m.

– Jemiclad commercial kitchen short wall



Fabricate an 18 gauge stainless steel 'U' shape capping with welded corners cleaned off flush. Make sure all edge are blunt and safe for cleaning.

Otherwise, arrange with your client how to finish and use either a Jemiclad F trim 1½ angle or thermoform the edges.

This is down to the client and installer to arrange.

– Cold weld joint detail

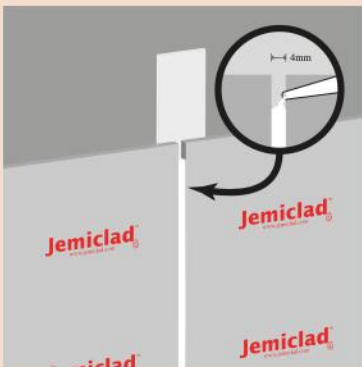

Install Jemiclad onto Jemifix double-sided tape, keeping the joint 4mm apart using a 4mm spacer.

Finishing the joint, remove protective film and wipe down with Jemiclad anti-static solution and prime the joint with Alu prime.

Just prior to finishing, install masking tape down both side of the joint, overfill the joint with Jemiclad sealant, use a filling knife to remove the excess sealant flush to the panels. Remove the masking tape within 30 seconds of applying sealant.

– Jemiclad to door architrave or door frame

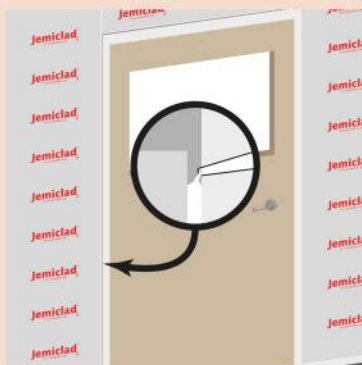

Install Jemiclad 2–4mm from the door detail to allow Jemiclad finish sealant to toe into the gap and become structural.

If there is door detail that the install needs to finish against, cap off Jemiclad with a start and edge trim.

- Vinyl floor joint detail

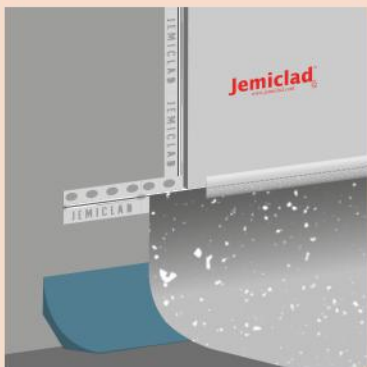

This specification is fine for semi-dry areas. If you're worried about water, always overlap the sheet vinyl with Jemiclad.

The Jemiclad vinyl trim gives the flooring contractor a capping to trim and fit sheet vinyl into.

- Vinyl floor overlay detail

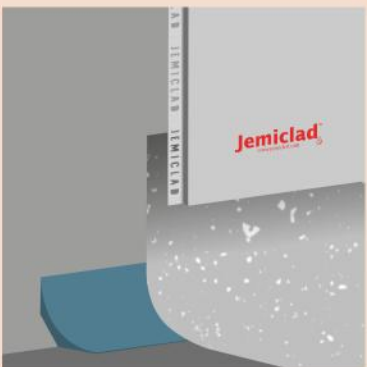

This method is a **must** for wet areas!

Sheet vinyl is installed 2 inches higher than the client's specified flash cove height. The sheet vinyl is installed with no finishing capping, just the neat edge.

The vinyl must be very well bonded on the flash cove as the Jemiclad is bonding onto the sheet vinyl.

Jemiclad is installed 2 inches past the sheet vinyl—this will allow water to run over onto the flash cove—no trim is used in the detail.

The front and back edge is trimmed clean with an aris front and back, a 15mm line of Jemifix clear sealant is run to the back edge of the panel, pressure is applied to the wall and the overspill is cleaned off.

- Cove base with cover former and capping seal



If the Jemiclad is installed to the floor, sheet vinyl can be installed on top. The flooring contractor is to specify cove base, capping trim and adhesive to be used.



Contact us

Please visit our North American websites.

www.jemiclادcanada.com

www.jemiclادusa.net

You can contact us by sending an email to info@jemiclادcanada.com or by visiting either of our websites.

Please let us know what questions you might have and what area you or your project is located.

We will then be able to answer your questions or forward your request to your local area reps or distributors.

Jemiclاد products are available throughout North America, Europe, The British Isles, Africa and UAE

info@jemiclادcanada.com

